

Nichols
893-3717

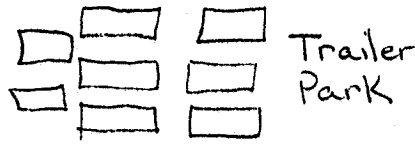

(If you go by the T.P., you missed the turn. Turn around!)

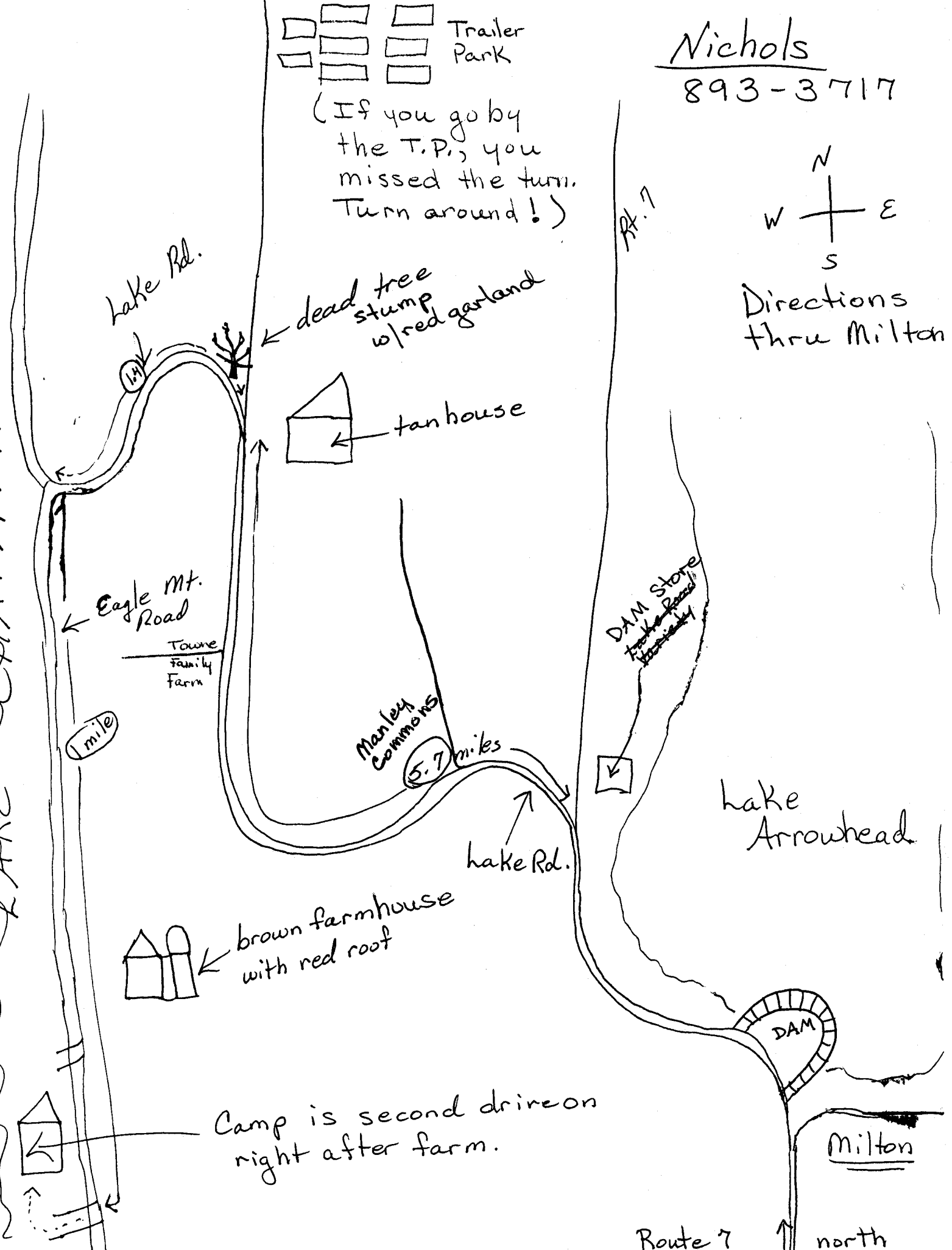
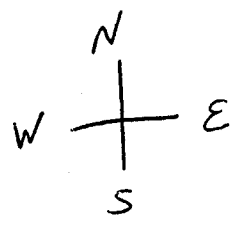

Lake Rd.

dead tree stump w/ red garland

tan house

Eagle Mt. Road

Towne Family Farm

1 mile

Manley Commons

5.7 miles

Lake Rd.

brown farmhouse with red roof

DAM Stone

Lake Arrowhead

DAM

Camp is second drive on right after farm.

Milton

Route 7

north

DIRECTIONS VIA ROUTE 7 THROUGH MILTON:

I-89 to Exit 17 (Milton/Islands exit - Chimney Corners exit). Take Route 7 north through Milton, crossing over new bridge at dam, continuing on 7 with Lake Arrowhead on your right. Take your first left onto Lake Road across from The Dam Store.

Continue on Lake Road 5.7 miles. At that point there will be a big corn field on left, a tan house on right, and a dead tree stump covered with vine and red garland on the northwest corner. Take left, continuing on Lake Road for 1.4 miles until you get to the lake. (If you miss the turn and pass a large trailer park on your right, turn around.)

At end of Lake Road, take left onto Eagle Mountain Harbor Road. Continue one mile on dirt road. Right after you pass a chocolate brown farm/silo with red roof on left, take your second right into driveway. Sign will say "225.) Our camp is back 300 feet on your right, yellow with light blue trim.

DIRECTIONS VIA ROUTE 2:

I-89 or Route 7 north to Exit 17 (Chimney Corners - Milton/Islands exit).

Route 2 west. Continue on Route 2 over Lamoille River, taking next right onto Bear Trap Road. Go up hill and stay on paved road till you come to a smelly red barn on left where the road forks. Take left fork. There's a white house directly across the road. Turn left at red barn. You're now on a dirt road.

Continue through the next stop sign, staying on Cadreact Road which crosses over Everest Road. Continue to next stop sign and take left onto Lake Road.

At end of Lake Road, take left onto Eagle Mountain Harbor Road. Continue one mile on dirt road. Right after you pass a chocolate brown farm/silo with red roof on left, take your second right into driveway. Sign will say "225." Our camp is back 300 feet on your right, yellow with light blue trim.